

**Applications**

Lifting of containers by their standard ISO corners.

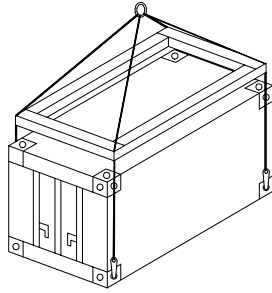

**CCV**

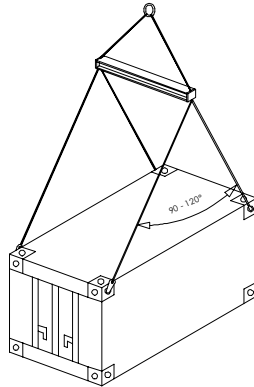

**CCB**

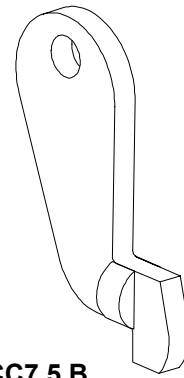
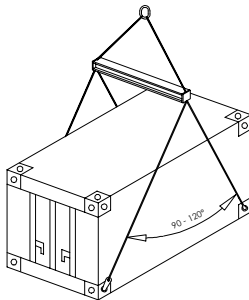
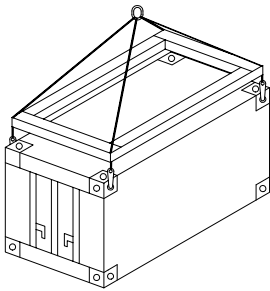

**CC7.5 B**



**CC7.5V**

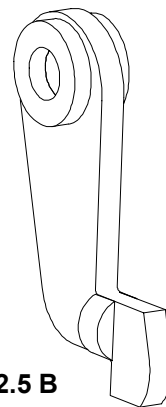

**CC12.5 B**

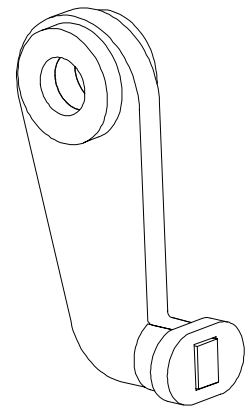

**CC12.5 V**

**Description**

2 models:

CCB: container lifted by the bottom, slantwise traction.

CCV: container lifted by the top or bottom, vertical traction.

Slings not provided.

**Functioning**

CCB: lifting with a single lifting beam and two 2-legged slings.

CCV: lifting with a spreader frame and 4 slings.

**Particular instructions**

- Do not use container lugs meant for slantwise traction (CCB) to pull vertically and vice versa.
- CCB container lugs for slantwise traction: adhere to a sling angle included between 90 and 120°.
- Working temperature: -20° to +100°C.

**General characteristics**

- Manufacture without load bearing welds.
- Hot epoxy coating.
- Safety factor: 4 in accordance with the European Materials Handling Federation (1998 FEM 3<sup>rd</sup> edition) ; working group A5 and lifting speed 60 m/ mn.

**Dimensional characteristics**

Ref.	Group code	WLL/ 4 kg	Traction	A	B	C	D	E	F	G	H	I	J	Weight/ 4 kg
CCV7,5	50038	30 000	vertical	16	55	32	160	44	99	X	20	50	77	16
CCV12,5	50048	50 000		25	55	40	160	44	99	50	20	50	77	20
CCB7,5	50058	30 000	slantwise	16	55	32	145	64	119	X	20	72	50	14
CCB12,5	50068	50 000		25	55	40	160	74	129	50	20	73	50	20

Dimensions in mm

