

# **pakrol<sup>®</sup>**

**skates and trolley skates**



 **Tractel** Group

# TRACTEL OFFERS A COMPLETE RANGE OF SKATES AND TROLLEY SKATES TO HANDLE AND MOVE MANUALLY HEAVY AND RIGID LOADS UP TO 20 t ON A FLAT AND RESISTANT FLOOR.



# paikroli®

## ADVANTAGES

- Robust frame
- Minimum maintenance
- Nylon wheels with ball bearings (except 8 t trolley skate with PU wheels)
- Handle for transport
- Trolley skate load plate with ball thrust bearings

## DESCRIPTION

To offer the best stability of the load and make its guiding easier, we recommend to share the load surface on **2 skates and 1 trolley skate**. (refer to the undermentioned sketch) :

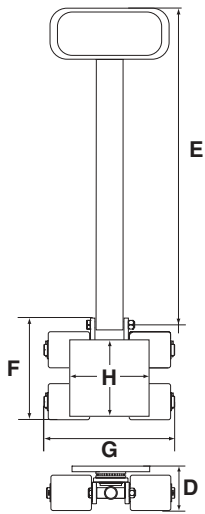

**Trolley skates  
4 wheels  
WLL = 4 t**

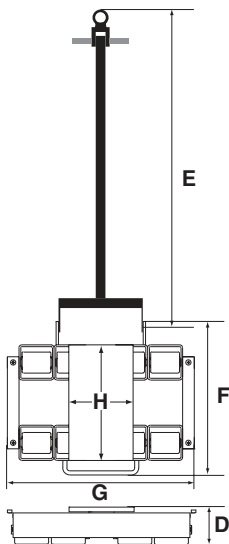

**Trolley skates  
8 wheels  
WLL = 6/8 t**

Total load	Trolley skate	Skate
8 t	4 t	+ 2 x 2 t
12 t	4 t	+ 2 x 4 t
14 t	6 t	+ 2 x 4 t
18 t	6 t	+ 2 x 6 t
20 t	8 t	+ 2 x 6 t

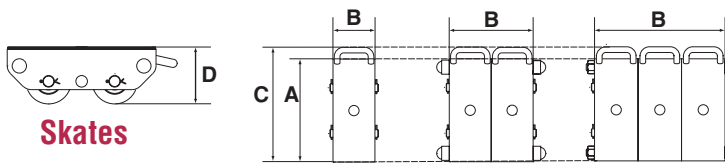
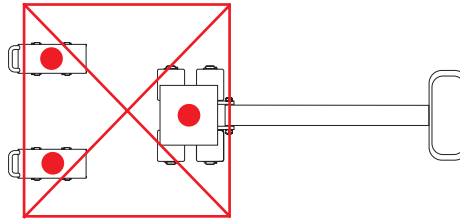

**Skates**

W.L.L.	Skate 2 t	Skate 4 t	Skate 6 t	Trolley skate 4 t	Trolley skate 6/8 t	
Weight (kg)	5	11	25	14	50	
Operating temperature range (°C)	-10 à +30 °	-10 à +30 °	-10 à +30 °	-10 à +30 °	-10 à +30 °	
Dimensions (mm)	A	270	270	270	-	-
	B	106	232	348	-	-
	C	308	308	308	-	-
	D	110	110	110	110	110
	E	-	-	-	940	1200
	F	-	-	-	230	530
	G	-	-	-	297	640
	H	-	-	-	145 x 180	400 x 220

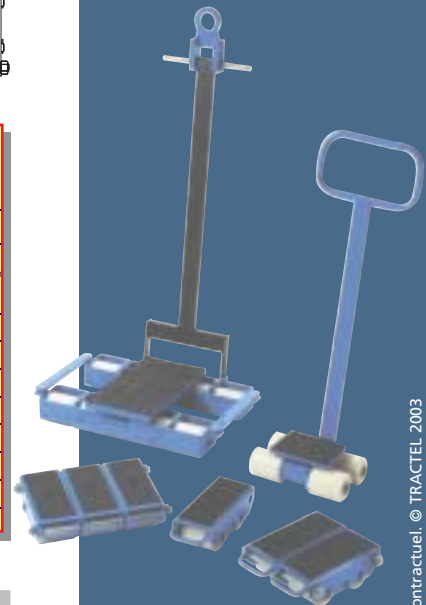

**TRACTEL S.A.S. :**  
 Saint-Hilaire-sous-Romilly  
 B.P. 38 - F-10102 Romilly-sur-Seine Cedex  
 Tél. +33 3 25 21 07 00  
 Fax. +33 3 25 21 07 11  
 ISO 9001



[www.tractel.com](http://www.tractel.com) - E-mail : [info@tractel.com](mailto:info@tractel.com)

**Export department :**  
 Tel. (352) 43 42 42-1  
 Fax (352) 43 42 42-200

**Paris region offices :**  
 Tel. +33 1 48 58 91 32  
 Fax +33 1 48 58 19 95